

## Description

Tri-lobular hex washer head screw - Steel

Tri-lobular thread rolling screws are used to create strong, uniform load carrying internal threads into untapped materials upon installation. Assembly efficiency and joint performance along with lower in-place fastening cost, are just some of the benefits of using Tri-lobular Screws. Tri-Lobe screws drive easier than other thread-forming screws, and with uniform torque. They are self-locking and vibration-resistant along the entire length of the thread.



**Material** Steel  
**Finish** Zinc

AISI 1022 (Grade 8.8)

## Specifications

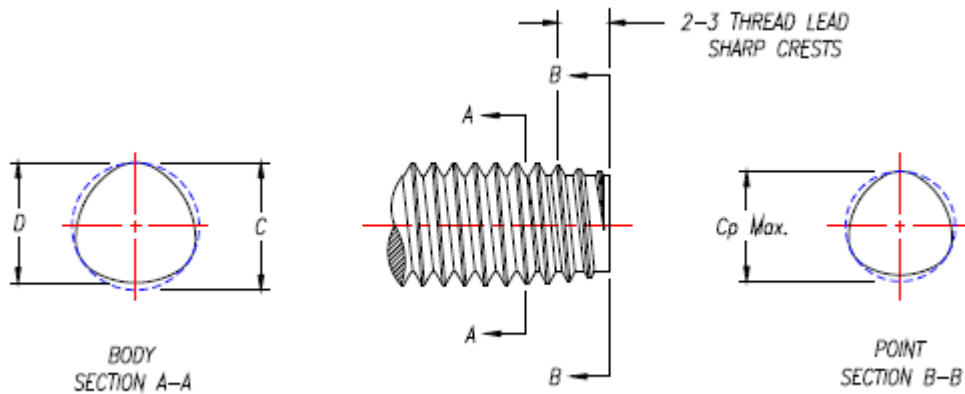

## Dimension

Nominal size	Screw body dimensions (mm)				Point
	C		D		Cp Max.
	Max	Min.	Max.	Min.	
<b>M8 x 1.25</b>	8.13	7.97	7.88	7.72	6.91
<b>M10 x 1.50</b>	10.15	9.97	9.85	9.67	8.69

Application Duty Class	Light - 0.3 Diameter of Material		Medium/Light - 0.5 Diameter of Material		Medium/Heavy - 0.75 Diameter of Material		Full Strength - 1.0 Diameter of Material		Extended - 1.25 Diameter of Material	
	Material Thickness	Pilot Hole	Material Thickness	Pilot Hole	Material Thickness	Pilot Hole	Material Thickness	Pilot Hole	Material Thickness	Pilot Hole
<b>M8 x 1.25</b>	1.6 - 3.1	7.27	3.1 - 4.9	7.31	4.6 - 6.9	7.35	6.9 - 8.9	7.39	8.9 - 10.9	7.43
<b>M10 x 1.50</b>	1.9 - 3.9	9.12	3.9 - 5.9	9.17	5.9 - 8.3	9.22	8.3 - 10.9	9.27	10.9 - 12.9	9.32
<b>Percentage of Thread</b>	90%		85%		80%		75%		70%	

Dimensions and specifications are subject to change without notice.  
Check your distributor for the latest data sheet

As this data is based on multiple tests in various thicknesses we recommend testing the fastener in your application when an exact strength figure is required, or the load to be applied comes close to the published data

Profast Pty Ltd QLD

P: +61 7 3265 2267

F: +61 7 3265 2257

E: salesQLD@profast.com.au

W: www.profast.com.au

Profast WA Pty Ltd

P: +61 8 9456 5537

F: +61 8 9455 2659

E: salesWA@profast.com.au

W: www.profast.com.au