

Description

Multi-grip dome head rivet - Aluminium/Steel

Optimal for applications where material thickness varies. The wide grip range ensures one rivet is suitable for a wide range of applications.



Material	Body:	Aluminium Alloy	ALMG 2.0/2.5
	Mandrel:	Carbon Steel	SAE 1006-1022
Finish	Body:	Bright finish surface	
	Mandrel:	Zinc Plated Cr VI free	

Specifications

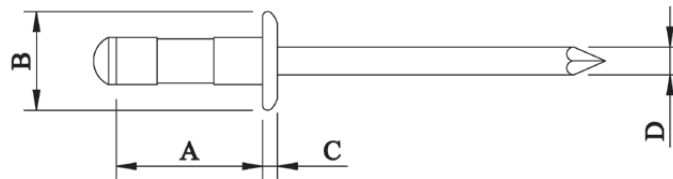

Dimensions

Part Code	Diameter	Grip Range	Hole Size +0.10	A -0.10	B ±0.05	C ±0.05	D ±0.10
TV61-0410	3.20 (1/8")	1.0 – 5.0	3.30	8.00	6.00	1.30	1.75
TV61-0416	3.20 (1/8")	4.5 – 9.0	3.30	12.00	6.00	1.30	1.75
TV61-0512	4.00 (5/32")	1.5 – 6.5	4.10	10.00	8.00	1.60	2.15
TV61-0516	4.00 (5/32")	3.5 – 8.5	4.10	12.00	8.00	1.60	2.15
TV61-0613	4.80 (3/16")	1.0 – 6.0	4.90	10.00	9.50	1.45	2.65
TV61-0619	4.80 (3/16")	5.0 – 11.0	4.90	15.00	9.50	1.45	2.65
TV61-0621	4.80 (3/16")	7.0 – 12.5	4.90	17.00	9.50	1.45	2.65
TV61-0631	4.80 (3/16")	12.5 – 20.0	4.90	25.00	9.50	1.45	2.65

Part Code	Shear Strength (Min) kN	Tensile Strength (Min) kN
TV61-04**	0.680	0.980
TV61-05**	1.150	1.600
TV61-06**	1.500	2.350

Dimensions and specifications are subject to change without notice.
Check your distributor for the latest data sheet

As this data is based on multiple tests in various thicknesses we recommend testing the fastener in your application when an exact strength figure is required, or the load to be applied comes close to the published data