

Description

4.8mm (3/16") High strength - Dome Head - Steel

Optimal for applications requiring high shear and tensile strength. The tail of the rivet forms into a mushroom head shape spreading the high clamp up force over a larger area and leaving a neat finish.



Material	Body:	Steel
	Mandrel:	Steel
Finish	Body:	Zinc Plated Cr VI free
	Mandrel:	Zinc Plated Cr VI free

Specifications

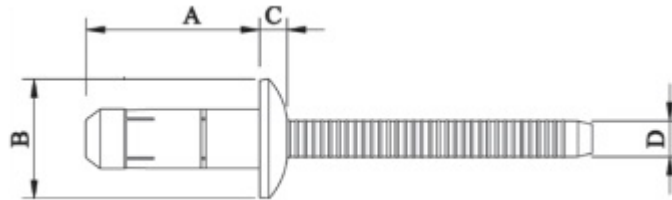

Dimensions

Part Code	Diameter	Grip Range	Hole Size ±0.1	A ±0.2	B -0.2	C ±0.05	D ±0.05
TLDR0611	4.80 (3/16")	1.5 – 3.5	5.00	12.10	9.60	1.50	3.10
TLDR0614	4.80 (3/16")	3.5 – 6.0	5.00	14.60	9.60	1.50	3.10
TLDR0618	4.80 (3/16")	6.0 – 8.5	5.00	17.60	9.60	1.50	3.10

Shear Strength

Part Code	Stem in shear plane	Stem outside shear plane	Tensile Strength
	kN	kN	kN
TLDR0611	4.200	N/A	3.800
TLDR0614	4.200	N/A	3.800
TLDR0618	4.200	N/A	3.800

Dimensions and specifications are subject to change without notice.
Check your distributor for the latest data sheet

As this data is based on multiple tests in various thicknesses we recommend testing the fastener in your application when an exact strength figure is required, or the load to be applied comes close to the published data