

Description

Mega Lock - Countersunk – Steel

Optimal for applications of varying thickness requiring high shear and tensile strengths with a flush finish. The dual locking grooves on the mandrel provide excellent resistance to vibration as well as impressive shear strength and weather resistance. This rivet offers excellent hole fill, generous grip range, pressure tight seal, and flush breaking mandrel regardless of material thickness.



Material	Body:	Low Carbon Steel	
	Mandrel:	Medium Carbon Steel	
Finish	Body:	Zinc Plated	Cr VI free
	Mandrel:	Zinc Plated	Cr VI free
Angle of Countersink		100 degree	

Specifications

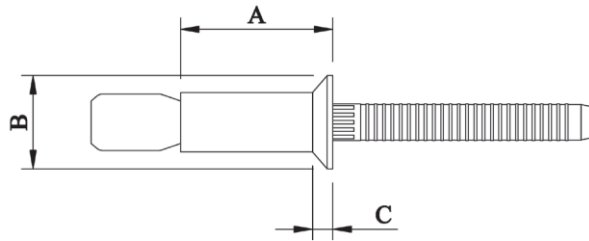

Dimensions

Part Code	Diameter	Grip Range	Hole Size	A	B	C
SR100-R606	4.80 (3/16")	3.2 – 8.4	5.00	12.30	8.60	1.80
SR100-R609	4.80 (3/16")	7.8 – 12.7	5.00	16.50	8.60	1.80
SR100-R807	6.40 (1/4")	4.1 – 12.1	6.80	16.70	10.00	2.00
SR100-R812	6.40 (1/4")	10.6 – 18.4	6.80	23.00	10.00	2.00
SR100-R1212	9.53 (3/8")	6.1 – 19.1	10.00	29.00	15.75	3.00

Part Code	Shear Strength KN	Tensile Strength KN
SR100-R06**	6.178	5.344
SR100-R08**	12.258	9.806
SR100-R1212	24.960	17.830

Dimensions and specifications are subject to change without notice.
Check you distributor for the latest data sheet

As this data is based on multiple tests in various thicknesses we recommend testing the fastener in your application when an exact strength figure is required, or the load to be applied comes close to the published data