

Description

Button head Max Grip pin – Steel

Two piece swage lock fastening system consisting of a pin and a collar. These fasteners are versatile due to their wide grip range, high speed assembly and high shear and tensile strengths. The fasteners offer high clamp up force and vibration resistance.



Specifications

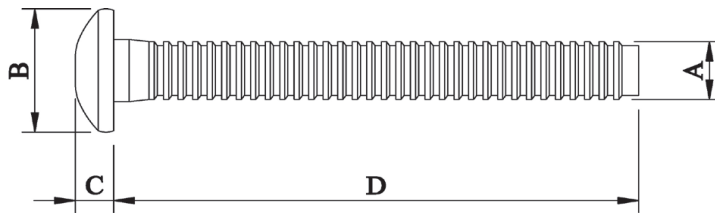

Dimensions

Part Code	Diameter	Grip Range	Hole Size Max	A -0.2	B Max	C Max	D Max
SPBR-0610	4.80 (3/16")	1.6 – 15.9	5.10	5.00	10.10	3.30	48.00
SPBR-0620	4.80 (3/16")	7.9 – 31.7	5.10	5.00	10.10	3.20	61.00
SPBR-00810	6.40 (1/4")	1.6 – 15.9	6.70	6.80	13.40	4.00	52.50
SPBR-00820	6.40 (1/4")	7.9 – 31.8	6.70	6.80	13.40	4.00	67.00
SPBR-1012	7.90 (5/16")	3.2 – 19.1	8.20	8.10	16.70	5.10	59.40
SPBR-1022	7.90 (5/16")	15.9 – 34.9	8.20	8.10	16.70	5.10	72.10
SPBR-1214	9.50 (3/8")	3.2 – 22.2	9.80	9.70	20.00	6.30	73.00
SPBR-1226	9.50 (3/8")	20.6 – 41.3	9.80	9.70	20.00	6.30	88.90

Part Code	Shear Strength KN	Tensile Strength KN	Clamp Force KN
SPBR-06**	7.500	6.205	4.000
SPBR-008**	9.800	11.305	5.300
SPBR-10**	13.345	17.394	9.580
SPBR-12**	18.682	25.021	14.260

Dimensions and specifications are subject to change without notice. Check you distributor for the latest data sheet

As this data is based on multiple tests in various thicknesses we recommend testing the fastener in your application when an exact strength figure is required, or the load to be applied comes close to the published data