

Description 4.8mm Countersunk sealed rivet – Aluminium/Steel

This POP® brand rivet is specially designed with the stem completely enclosed within the body of the rivet. Sealed rivets are recommended for fixing in applications where a water resistant or pressure tight fixing is required. This multi-purpose rivet is suitable for general fastening in light to medium duty applications where a flush finish is required



Material Body: Aluminium AIMg5
Mandrel: Carbon Steel

Finish Clean

Specifications

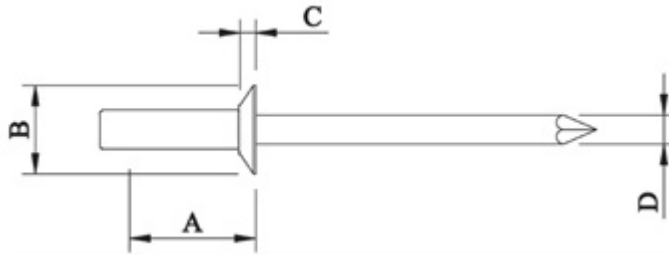

Dimensions

Part Code	Diameter	Grip Range	Hole Size	A	B ±0.3	C	D
P-AK62SB	4.80 (3/16")	Up to 4.7	5.0 – 5.1	10.00	9.55	-	2.62
P-AK63SB	4.80 (3/16")	4.7 – 6.3	5.0 – 5.1	11.50	9.55	-	2.62
P-AK64SB	4.80 (3/16")	6.3 – 7.9	5.0 – 5.1	13.00	9.55	-	2.62
P-AK65SB	4.80 (3/16")	7.9 – 9.4	5.0 – 5.1	14.70	9.55	-	2.62
P-AK66SB	4.80 (3/16")	9.4 – 11.0	5.0 – 5.1	16.30	9.55	-	2.62
P-AK68SB	4.80 (3/16")	11.0 – 14.2	5.0 – 5.1	19.50	9.55	-	2.62
P-AK610SB	4.80 (3/16")	14.2 – 18.4	5.0 – 5.1	23.50	9.55	-	2.62

Shear Strength

Part Code	Stem in shear plane kN	Stem outside shear plane kN	Tensile Strength kN
P-AK6xSB	2.260	N/A	3.110

Dimensions and specifications are subject to change without notice.
Check your distributor for the latest data sheet

As this data is based on multiple tests in various thicknesses we recommend testing the fastener in your application when an exact strength figure is required, or the load to be applied comes close to the published data