

## Description

6.5mm (1/4") Orlock - Dome Head - Steel

Orlock is one of our highest strength structural rivets. The blindside upset is bulbed which helps spread the clamp force so that the joint material is not deformed. The bulbed tail also leaves a neat finish with minimal protrusion on the blind side. The dual locking grooves on the mandrel provide excellent resistance to vibration as well as impressive shear strength and weather resistance.



<b>Material</b>	Body:	Low Carbon Steel
	Mandrel:	Carbon Steel
<b>Finish</b>	Body:	Zinc Plated Cr VI free*
	Mandrel:	Zinc Plated Cr VI free

\*Colour tint available on request and supplied with a suffix  
eg. BLDRC-08105XGG for gold,  
BLDRC-08105XGV for violet

## Specifications

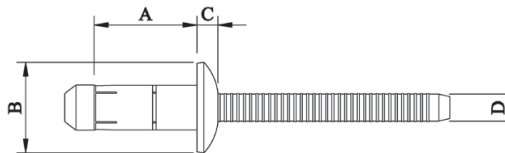

## Dimensions

Part Code	Diameter	Grip Range	Hole Size ±0.1	A ±0.2	B ±0.1	C ±0.05	D ±0.05
BLDRC-08105XG	6.50 (1/4")	2.0 – 4.5	6.80	10.50	13.00	3.00	4.20
BLDRC-08125XG	6.50 (1/4")	3.0 – 6.5	6.80	12.50	13.00	3.00	4.20
BLDRC-08145XG	6.50 (1/4")	5.0 – 8.5	6.80	14.50	13.00	3.00	4.20
BLDRC-08165XG	6.50 (1/4")	7.0 – 10.5	6.80	16.50	13.00	3.00	4.20
BLDRC-08185XG	6.50 (1/4")	9.0 – 12.5	6.80	18.50	13.00	3.00	4.20
BLDRC-08205XG	6.50 (1/4")	11.0 – 14.5	6.80	20.50	13.00	3.00	4.20
BLDRC-08225XG	6.50 (1/4")	13.0 – 16.5	6.80	22.50	13.00	3.00	4.20
BLDRC-08245	6.40 (1/4")	16.8 – 18.8	6.70	24.50	13.00	3.00	4.20
BLDRC-08265	6.40 (1/4")	18.8 – 20.8	6.70	26.50	13.00	3.00	4.20
BLDRC-08285	6.40 (1/4")	20.8 – 22.8	6.70	28.50	13.00	3.00	4.20
BLDRC-08305	6.40 (1/4")	22.8 – 24.8	6.70	30.50	13.00	3.00	4.20
BLDRC-08325	6.40 (1/4")	24.8 – 26.8	6.70	32.50	13.00	3.00	4.20
BLDRC-08355	6.40 (1/4")	25.8 – 28.8	6.70	35.50	13.00	3.00	4.20
BLDRC-08375	6.40 (1/4")	27.8 – 30.8	6.70	37.50	13.00	3.00	4.20

### Shear Strength

Part Code	Stem in shear plane		Stem outside shear plane		Tensile Strength (nom)	
		kN		kN		kN
BLDRC-08105XG		10.787		N/A		7.943
BLDRC-08125XG		12.258		N/A		7.943
BLDRC-08145XG		13.729		N/A		7.943
BLDRC-08165XG		14.219		N/A		7.943
BLDRC-08185XG - 08225XG		15.396		N/A		7.943
BLDRC-08245 - 08375		11.179		N/A		6.472

Dimensions and specifications are subject to change without notice.  
Check your distributor for the latest data sheet

As this data is based on multiple tests in various thicknesses we recommend testing the fastener in your application when an exact strength figure is required, or the load to be applied comes close to the published data