

## Description

Orbulb tri-fold dome head rivet - Aluminium

Optimal for applications requiring the tensile load to be spread over a large area, such as when fastening into plastics, fibreglass and other composite material. During installation, the rivet body folds into 3 separate legs, creating a large load bearing area, and minimising the possibility of damage to the parent materials.



<b>Material</b>	Body:	Aluminium Alloy	2.5Mg to AA 5052
	Mandrel:	Aluminium Alloy	2.5Mg to AA 5052
<b>Finish</b>	Body:	Bright finish surface	
	Mandrel:	Natural	

## Specifications

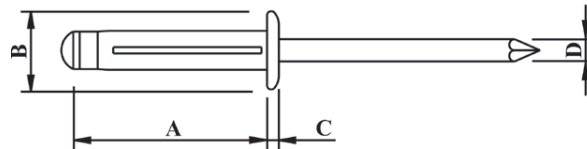

## Dimensions

Part Code	Diameter	Grip Range	Hole Size ±0.15	A ±0.2	B ±0.1	C ±0.05	D ±0.1
BB40188D	5/32"	1.0 – 7.0	4.30	18.80	8.00	1.40	2.30
BB48205D	3/16"	1.0 – 9.0	5.15	20.50	9.80	1.80	2.90
BB48205LF	3/16"	1.0 – 9.0	5.15	24.00	15.90	2.00	2.90
BB48240D	3/16"	4.0 – 12.0	5.15	24.00	9.80	1.80	2.90
BB48240LF	3/16"	4.0 – 12.0	5.15	24.00	15.90	2.00	2.90

### Shear Strength

Part Code	Stem in shear plane kN	Stem outside shear plane kN	Tensile Strength kN
BB40****	0.598	N/A	1.000
BB48****	0.902	N/A	1.196

Dimensions and specifications are subject to change without notice.  
Check your distributor for the latest data sheet

As this data is based on multiple tests in various thicknesses we recommend testing the fastener in your application when an exact strength figure is required, or the load to be applied comes close to the published data