

## Description

Multi-grip dome head rivet - Aluminium/Stainless

Optimal for applications where material thickness varies and a stainless mandrel is required to prevent rust trails. The wide grip range ensures one rivet is suitable for a wide range of applications.



<b>Material</b>	Body:	Aluminium Alloy	AA 5052
	Mandrel:	Stainless Steel	Series 400
<b>Finish</b>	Body:	Natural	
	Mandrel:	Natural	

## Specifications

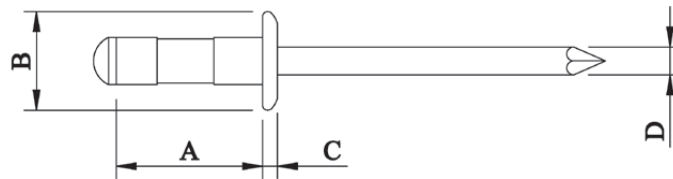

## Dimensions

Part Code	Diameter	Grip Range	Hole Size +0.1	A -0.1	B ±0.05	C ±0.05	D ±0.1
AV71-0621	4.80 (3/16")	6.4 – 12.7	4.90	16.90	9.80	1.45	2.80
AV71-0631	4.80 (3/16")	12.7 – 19.8	4.90	24.80	9.80	1.45	2.80

### Shear Strength

Part Code	Stem in shear plane kN	Stem outside shear plane kN	Tensile Strength kN
AV71-06**	1.559	N/A	2.353

Dimensions and specifications are subject to change without notice.  
Check your distributor for the latest data sheet

As this data is based on multiple tests in various thicknesses we recommend testing the fastener in your application when an exact strength figure is required, or the load to be applied comes close to the published data