

Description

Multi-grip dome head rivet- Steel/Steel

Optimal for applications where material thickness varies. The wide grip range ensures one rivet is suitable for a wide range of applications.



Material	Body:	Low Carbon Steel	SAE 1006
	Mandrel:	Carbon Steel	SAE 1006-1040
Finish	Body:	Zinc Plated Cr VI free	
	Mandrel:	Zinc Plated Cr VI free	

Specifications

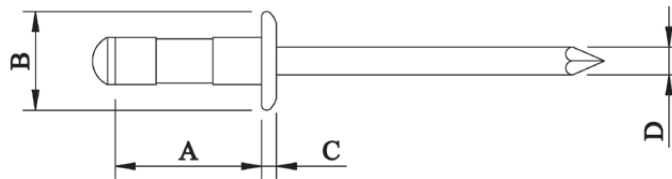

Dimensions

Part Code	Diameter	Grip Range	Hole Size +0.1	A -0.1	B ±0.05	C ±0.05	D ±0.1
AV25-0412	3.2 (1/8")	1.0 – 4.0	3.30	9.00	7.20	0.85	2.10
AV25-0416	3.2 (1/8")	1.0 – 9.0	3.30	13.00	7.20	0.85	2.10
AV25-0518	4.0 (5/32")	1.4 – 8.0	4.10	14.00	8.10	1.20	2.73
AV25-0614	4.8 (3/16")	1.0 – 6.0	4.90	11.00	9.80	1.45	2.90
AV25-0618	4.8 (3/16")	1.0 – 9.0	4.90	14.00	9.80	1.45	2.90
AV25-0622	4.8 (3/16")	3.0 – 12.0	4.90	17.00	9.80	1.45	2.90

Shear Strength

Part Code	Stem in shear plane kN	Stem outside shear plane kN	Tensile Strength kN
AV25-04**	1.510	N/A	1.716
AV25-05**	1.961	N/A	2.353
AV25-06**	4.413	N/A	3.824

Dimensions and specifications are subject to change without notice.
Check your distributor for the latest data sheet

As this data is based on multiple tests in various thicknesses we recommend testing the fastener in your application when an exact strength figure is required, or the load to be applied comes close to the published data