

## Description

Multi-grip dome head rivet- Steel/Steel

Optimal for high strength and high clamp applications. The tail end of the rivet forms into a mushroom head shape on setting offering high clamp up force and a neat finish.



<b>Material</b>	Body:	Low Carbon Steel
	Mandrel:	Carbon Steel
<b>Finish</b>	Body:	Zinc Plated Cr VI free
	Mandrel:	Zinc Plated Cr VI free

## Specifications

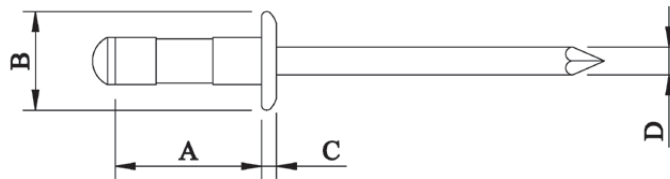

## Dimensions

Part Code	Diameter	Grip Range	Hole Size	A	B	C	D
				-0.1	±0.05	±0.05	±0.1
AV24-0514	4.0 (5/32")	1.4 – 5.0	4.10	11.00	8.10	1.20	2.73
AV24-0612	4.8 (3/16")	1.2 – 4.8	4.90	10.30	9.80	1.75	3.38
AV24-0616	4.8 (3/16")	4.0 – 6.3	4.90	12.70	9.80	1.75	3.38

### Shear Strength

Part Code	Stem in shear plane	Stem outside shear plane	Tensile Strength
	kN	kN	kN
AV24-0514	1.961	N/A	2.353
AV24-0612	3.599	N/A	3.334
AV24-0616	4.560	N/A	3.461

Dimensions and specifications are subject to change without notice. Check your distributor for the latest data sheet

As this data is based on multiple tests in various thicknesses we recommend testing the fastener in your application when an exact strength figure is required, or the load to be applied comes close to the published data