

Description

9.5mm Button head lock bolt pin – Steel

Two piece swage lock fastening system consisting of a pin and a collar. These fasteners offer very high shear and tensile strengths, while being quick and easy to install. These fasteners offer high clamp up force and vibration resistance.



Specifications

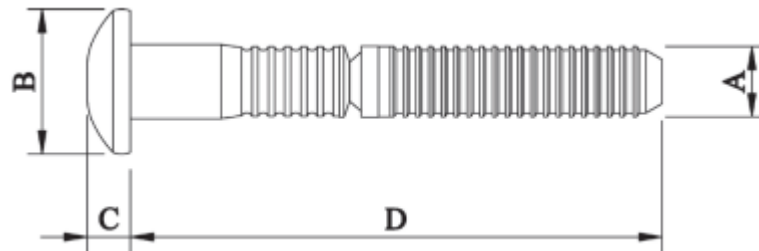

Dimensions

Part Code	Diameter	Grip Range	Hole Size -0.2	A -0.2	B -2.0	C Max	D	Break ±0.9
PLB-1204	9.50 (3/8")	3.2 – 9.5	10.00	9.80	20.00	6.30	57.50	20.50
PLB-1206	9.50 (3/8")	6.4 – 12.7	10.00	9.80	20.00	6.30	60.50	23.70
PLB-1208	9.50 (3/8")	9.5 – 15.9	10.00	9.80	20.00	6.30	63.50	26.90
PLB-1210	9.50 (3/8")	12.7 – 19.1	10.00	9.80	20.00	6.30	67.00	30.00
PLB-1212	9.50 (3/8")	15.9 – 22.2	10.00	9.80	20.00	6.30	70.00	33.20
PLB-1214	9.50 (3/8")	19.1 – 25.4	10.00	9.80	20.00	6.30	73.50	36.40
PLB-1216	9.50 (3/8")	22.2 – 28.6	10.00	9.80	20.00	6.30	76.50	39.60
PLB-1218	9.50 (3/8")	25.4 – 31.8	10.00	9.80	20.00	6.30	79.50	42.70

Part Code	Shear Strength kN	Tensile Strength kN	Clamp Load kN
PLB-12**	30.500	28.000	17.800

*Strength and clamp figures for guidance only. Based on pins without a surface finish. Zinc plating will reduce tensile strength by approximately 15%

Dimensions and specifications are subject to change without notice.
Check your distributor for the latest data sheet

As this data is based on multiple tests in various thicknesses we recommend testing the fastener in your application when an exact strength figure is required, or the load to be applied comes close to the published data

Profast Pty Ltd QLD

P: +61 7 3265 2267

F: +61 7 3265 2257

E: salesQLD@profast.com.au

W: www.profast.com.au

Profast WA Pty Ltd

P: +61 8 9456 5537

F: +61 8 9455 2659

E: salesWA@profast.com.au

W: www.profast.com.au